

# Rendex Mouldings

## Arches

### Cost

\$75 + Base

Base ~ \$1.10 every 10mm

Mouldings less than 70mm thick. (includes all architraves, bands and chords)

~ \$1.40 every 10mm

Mouldings 71mm to 110mm in thickness

~ \$1.70 every 10mm

Mouldings over 110mm

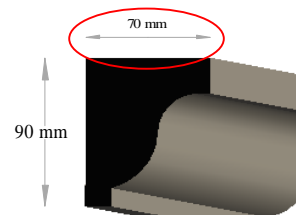

### Examples

<u>Base</u>	<u>Arch</u>		<u>Base</u>	<u>Total</u>	
654mm	\$75.00	\$71.50	{65x\$1.10}	\$146.50	plus gst
976mm	\$75.00	\$106.70	{97x\$1.10}	\$181.70	plus gst
1755mm	\$75.00	\$192.50	{175x\$1.10}	\$267.50	plus gst

GUARANTEED\* lead time for Arches

# 7 days

\*Ex factory - 24 Humphries Tce, Kilkenny  
 \*Only arches with a completed "PWS Arch Order Form"

[www.prestigewallsystems.com.au](http://www.prestigewallsystems.com.au)

**PWS**  
 Prestige Wall Systems

# Rendex Mouldings

## PWS Arch Order Form

Do not use - photocopy and keep original for future use

We require TWO measurements:

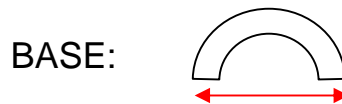

There are two types of arches that require either O.D. (outside diameter) or I.D. (inside diameter)  
 Specifying the wrong type will result in incorrect manufacture.  
 As arches are all custom - this will result in double payment.

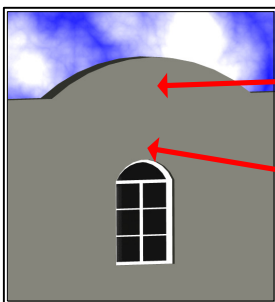

Parapet arch requiring an O.D.

Window arch requiring an I.D.

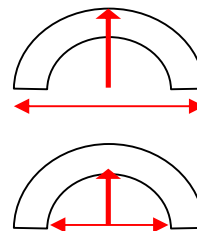

	Base (mm)	Rise(mm)	Profile	OD or ID
Arch 1				
Arch 2				
Arch 3				
Arch 4				
Arch 5				

Name: \_\_\_\_\_

Company: \_\_\_\_\_

Order Number: \_\_\_\_\_

Date: \_\_\_\_\_

Signature \_\_\_\_\_

Fax completed form to (08) 8244 1999